

# Cortical

Cortical implants provide good stability for immediate loading. Its sharp, deep threads provide extremely strong retention for primary implant stability.

The threads' location gives stability in the cortical bone. The Cortical system can be used in extraction sites for immediate implantation. Cortical is available in different sizes to suit any implantation site.

*Material: Titanium (Ti6Al4V ELI)*

*Treatment: RBM*

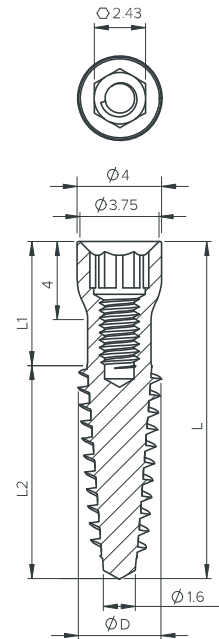



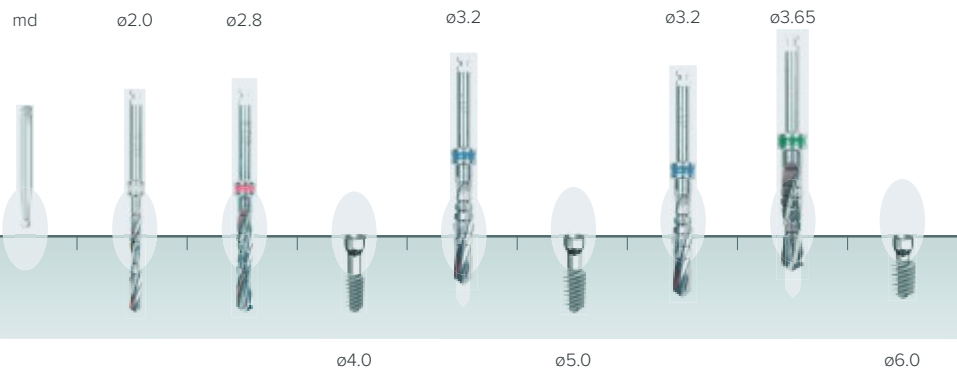

**Drill Sequence\***  
Bone type D1, D2

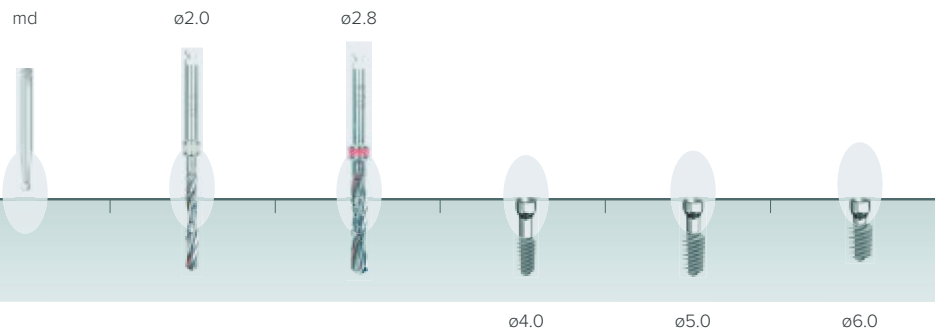

**Drill Sequence\***  
Bone type D3, D4



\* The proposed procedure is only a recommendation and should not replace the doctor's judgment. The implants may be placed in immediate function when good primary stability has been achieved and with appropriate occlusal loading.

Implants	Ø D (mm)	L (mm)	L1 (mm)	L2 (mm)	Item
	4.0	10	4.5	5.5	NM-M4010
		11.5	4.7	6.8	NM-M4011
		13	5	8	NM-M4013
		16	6	10	NM-M4016
		18	7	11	NM-M4018
		20	7.5	12.5	NM-M4020
	5.0	8	4.1	3.9	NM-M5008
		10	4.5	5.5	NM-M5010
		11.5	4.7	6.8	NM-M5011
		13	5	8	NM-M5013
		16	6	10	NM-M5016
			6.0	8	4.1
10	4.5			5.5	NM-M6010
11.5	4.7			6.8	NM-M6011
13	5			8	NM-M6013
<b>Cover Screw</b> Included with all implants  NM-S5023					

